

DIMENSIONS:

30" tall x 28" wide x 24.5" deep

30" tall x 34" wide x 24.5" deep

TOOL CABINETS (Standard Configuration):

1 - 4" drawer or 2 - 2" drawers

1 - Galvanized steel shelf

AVAILABLE COLOURS:

Cabinets are supplied with a textured powder coated black frame & side panels. Cabinet doors are available in six standard colors: black, white, red, orange, royal blue and yellow.

*Custom colours are available
(see your local dealer for details).

**FEATURES:**

- 100% modular for expandability
- 100% Canadian made
- Doors are double sided for extra strength and durability
- Cabinets are constructed from 16 gauge steel providing: higher strength, greater rigidity, tighter tolerances, and longer life.
- Rolled edges; no burrs or sharp edges
- Textured chrome latch - Standard (matte black optional)
- Stainless steel full length hinges
- Textured powder coated paint; reduces scuffs and fingerprints, easily cleaned
- 1/4" x 2" slotted mounting holes for easy installation and adjustability

1 & 2 DRAWER CABINETS

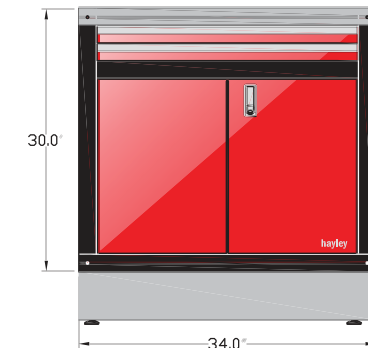
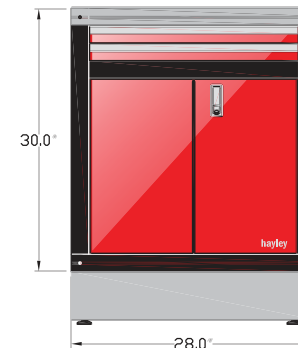
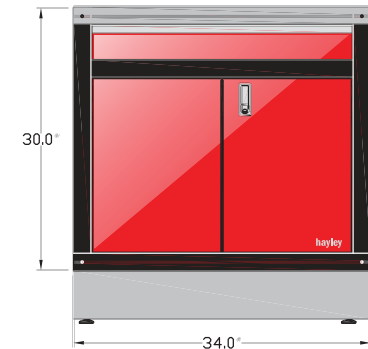

DIMENSIONS:

30" tall x 28" wide x 24.5" deep

30" tall x 34" wide x 24.5" deep

TOOL CHEST (Standard Configuration):

2 - 2", 4 - 4", 1 - 6" drawer

AVAILABLE COLOURS:

Cabinets are supplied with a textured powder coated black frame & side panels. Cabinet doors are available in six standard colors: black, white, red, orange, royal blue and yellow.

*Custom colours are available
(see your local dealer for details).

**FEATURES:**

- 100% modular for expandability
- 100% Canadian made
- Doors are double sided for extra strength and durability
- Cabinets are constructed from 16 gauge steel providing: higher strength, greater rigidity, tighter tolerances, and longer life.
- Rolled edges; no burrs or sharp edges
- Textured chrome latch - Standard (matte black optional)
- Stainless steel full length hinges
- Textured powder coated paint; reduces scuffs and fingerprints, easily cleaned
- 1/4" x 2" slotted mounting holes for easy installation and adjustability

TOOL CHEST

